

Mounting

# ALUMINUM PROFILE

for sauna & steam proof neon LED strip

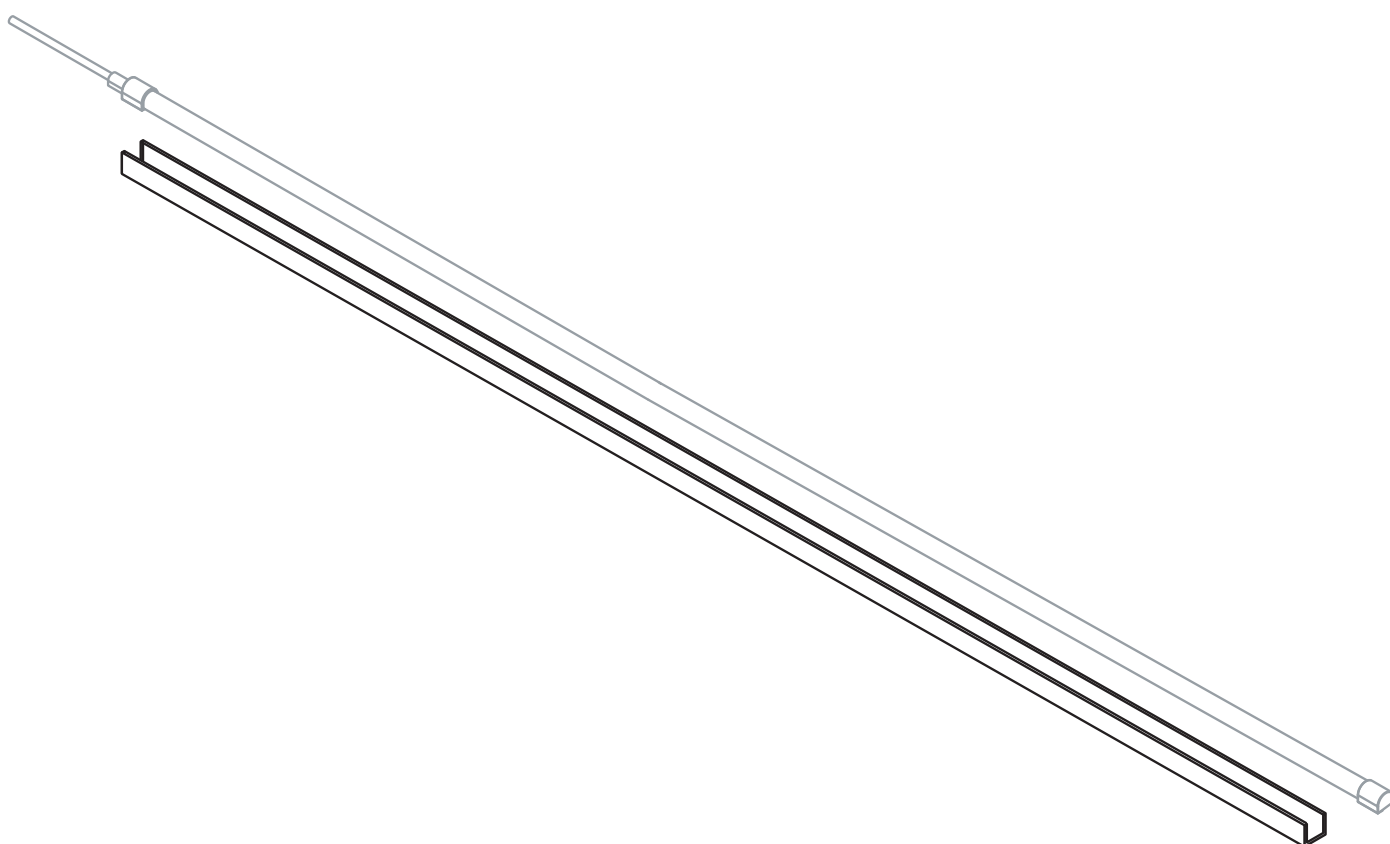

## Installation instruction

## The parts of Steam Proof NEON LED strip 6 m

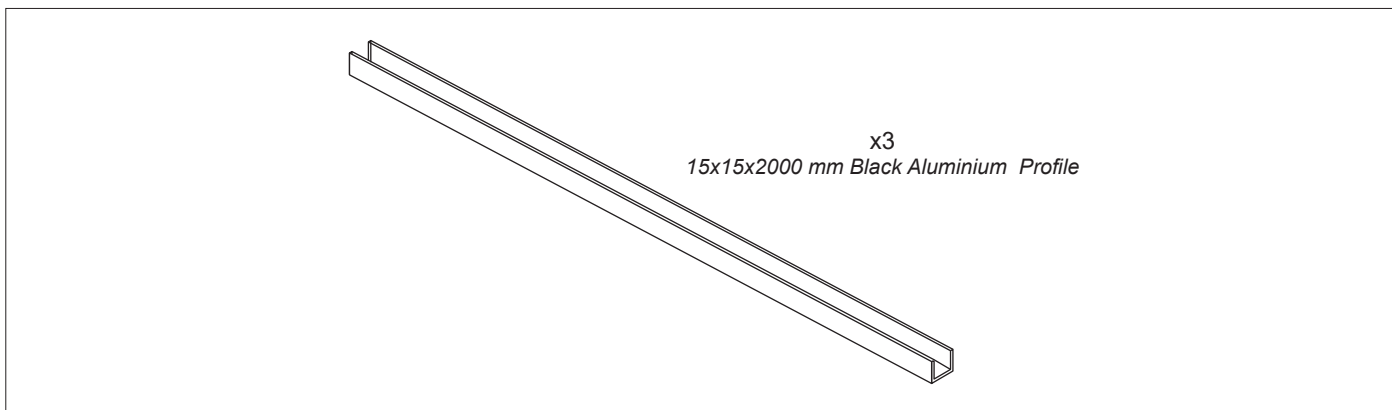

### Mounting

The profile has both holes for screws and double sided tape if it should be mounted with silicone.

1. Fasten with screws or put silicone and use the double sided tape to keep it fixated during the time to cure.
2. When secured on the surface, push down the strip into the profile, use soap water to make it easier.

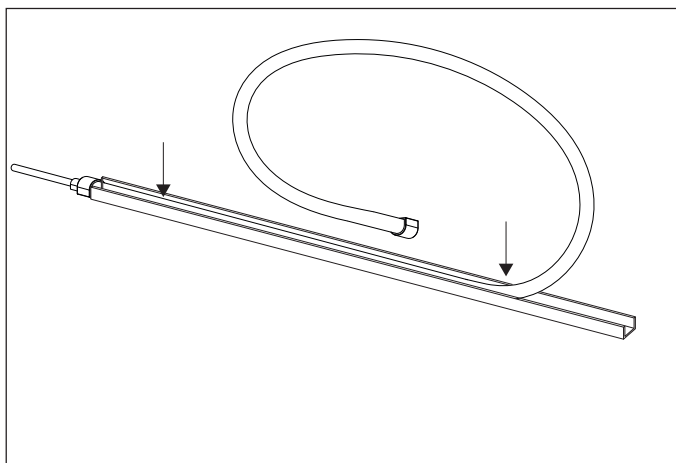

# TYLÖ

For other languages please contact [marketing@sauna360.com](mailto:marketing@sauna360.com)